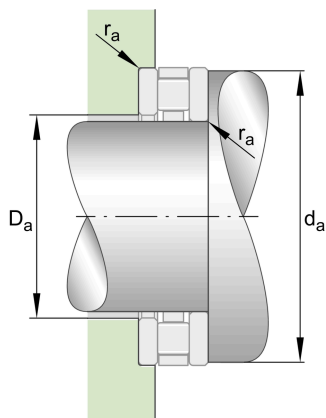
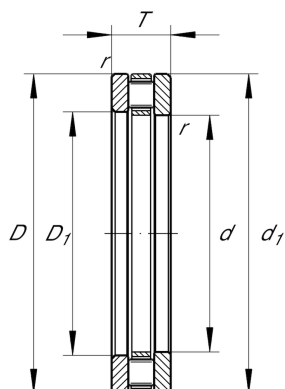
**81111-TV**

Axial cylindrical roller bearing

Schaeffler ID:
0007105470000Axial cylindrical roller bearings 811, single
direction, comprising K811, GS, WS

Technical information

**Main Dimensions & Performance Data**

d	55 mm	Bore diameter
D	78 mm	Outside diameter
T	16 mm	Height
C_a	90,000 N	Basic dynamic load rating, axial
C_{0a}	300,000 N	Basic static load rating, axial
C_{ua}	31,500 N	Fatigue load limit, axial
n_G	4,350 1/min	Limiting speed
n_{gr}	1,350 1/min	Reference speed
	0.002 kg	Weight

Additional information

	K81111-TV	Axial roller and cage assembly
D_1	57 mm	Bore diameter housing washer
	GS81111	Housing Washer
d_1	78 mm	Rip diameter shaft washer
	WS81111	Shaft washer
	LS5578	Track Washer
r_{min}	0.6 mm	Minimum chamfer dimension

Mounting dimensions

$d_{a min}$	77 mm	Minimum diameter shaft shoulder
$D_{a max}$	56 mm	Maximum diameter of housing shoulder
$r_{a max}$	0.6 mm	Maximum recess radius

Temperature range

T_{min}	120 °C	Operating temperature min.
T_{max}	-30 °C	Operating temperature max.